

plie

sofá-cama 2 lugares

TOK&STOK

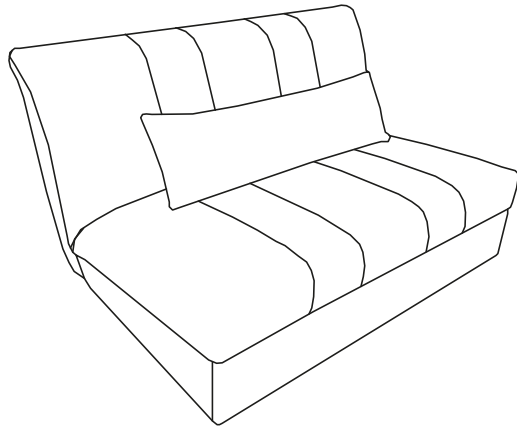

1
pessoas necessárias
para montar
o produto



médio
grau de
dificuldade



200
Kg
capacidade máxima
suportável, distribuída
uniformemente



Não utilizar produtos
químicos, abrasivos ou
limpeza a vapor.



Evitar o contato com
objetos cortantes e
exposição prolongada
ao sol.



Tecido: aspirador de pó ou
escova com cerdas macias.
Metal: pano levemente
umedecido com água,
seguido de pano seco.

partes do produto

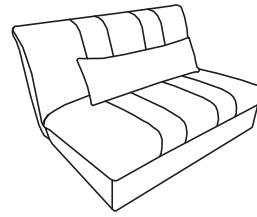

1 Estrutura (1x)

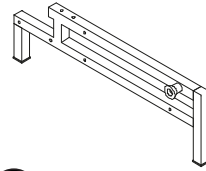

3 Pé lateral B (1x)



5 Pé menor A (1x)

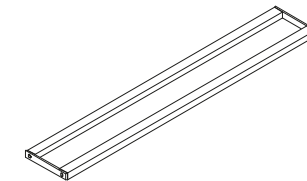

7 Travessa
de união (1x)

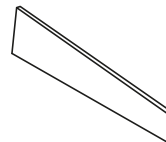

9 Montante de apoio (2x)

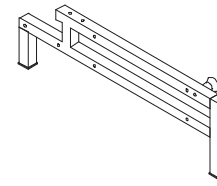

2 Pé lateral A (1x)



4 Pé intermediário (2x)



6 Pé menor B (1x)

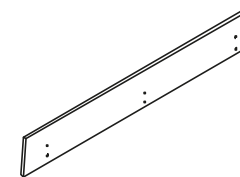

8 Travessa lateral (1x)

componentes



A- Chave allen (1x)

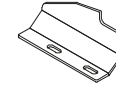

B- Chapa de apoio A (1x)

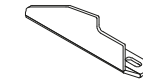

C- Chapa de apoio B (1x)



D- Parafuso M8x20 (24x)

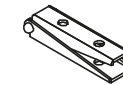

E- Suporte metálico (2x)



F- Parafuso M8x45 (4x)



G- Parafuso M6x20 (20x)



H- Chapa L 83° (3x)

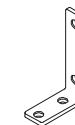

I- Chapa L 90° (4x)

1

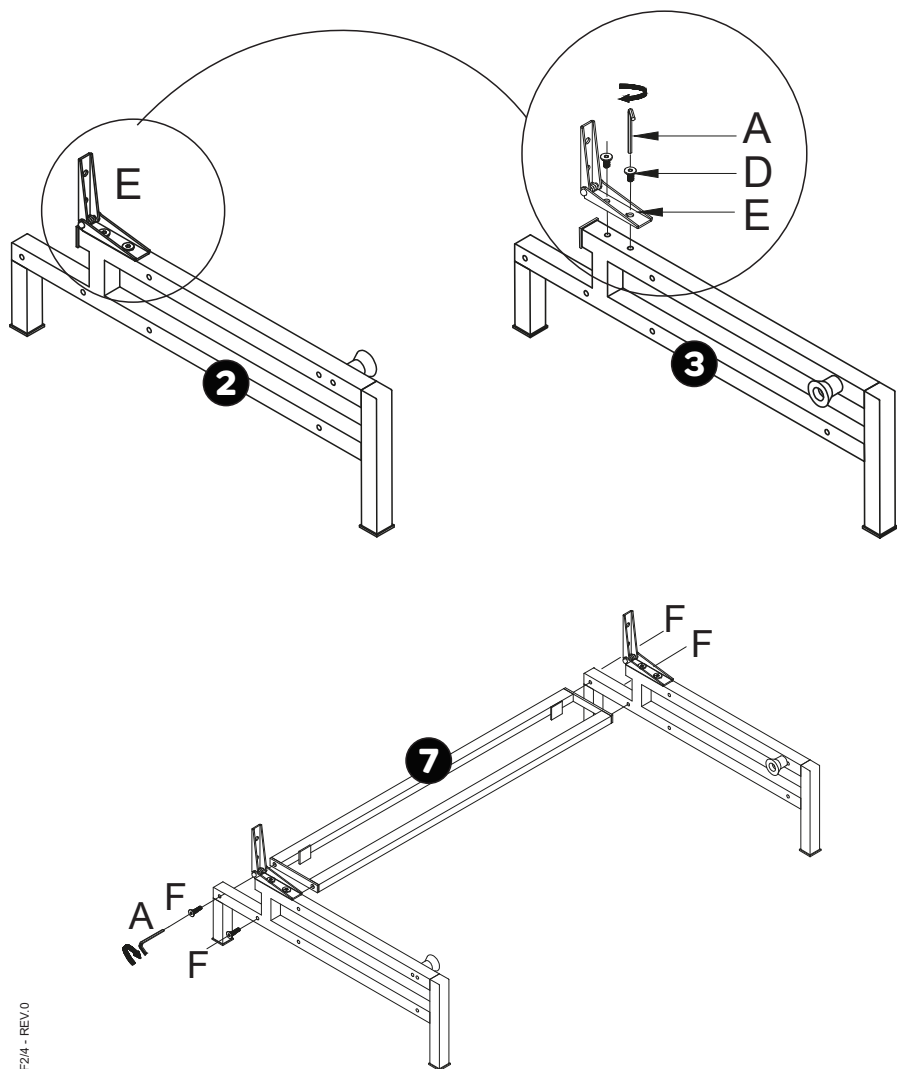

2

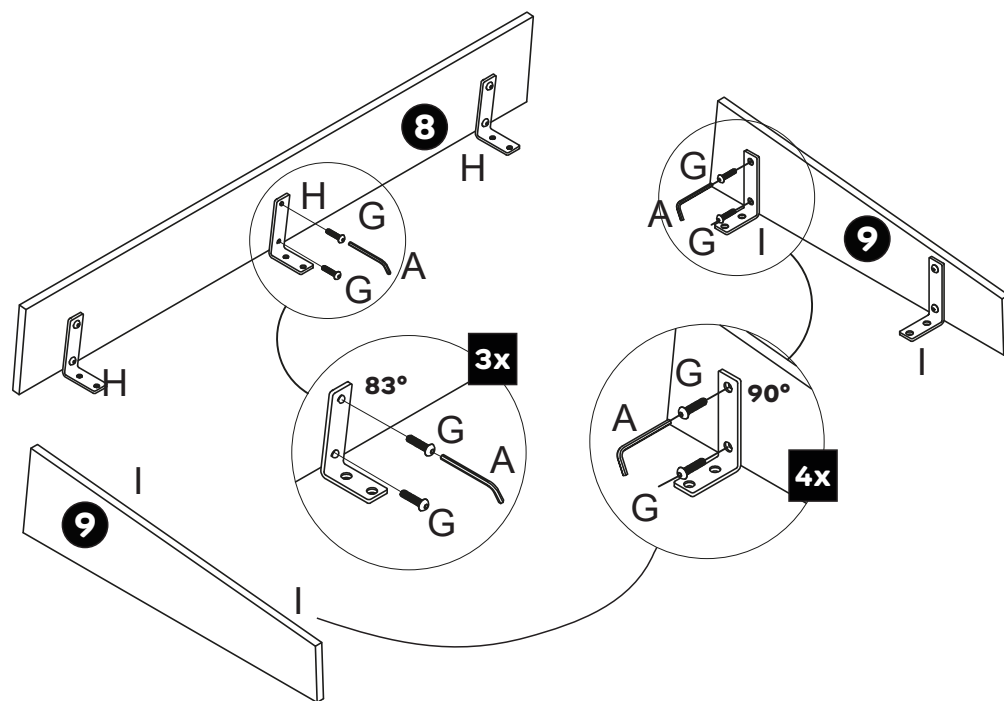

3

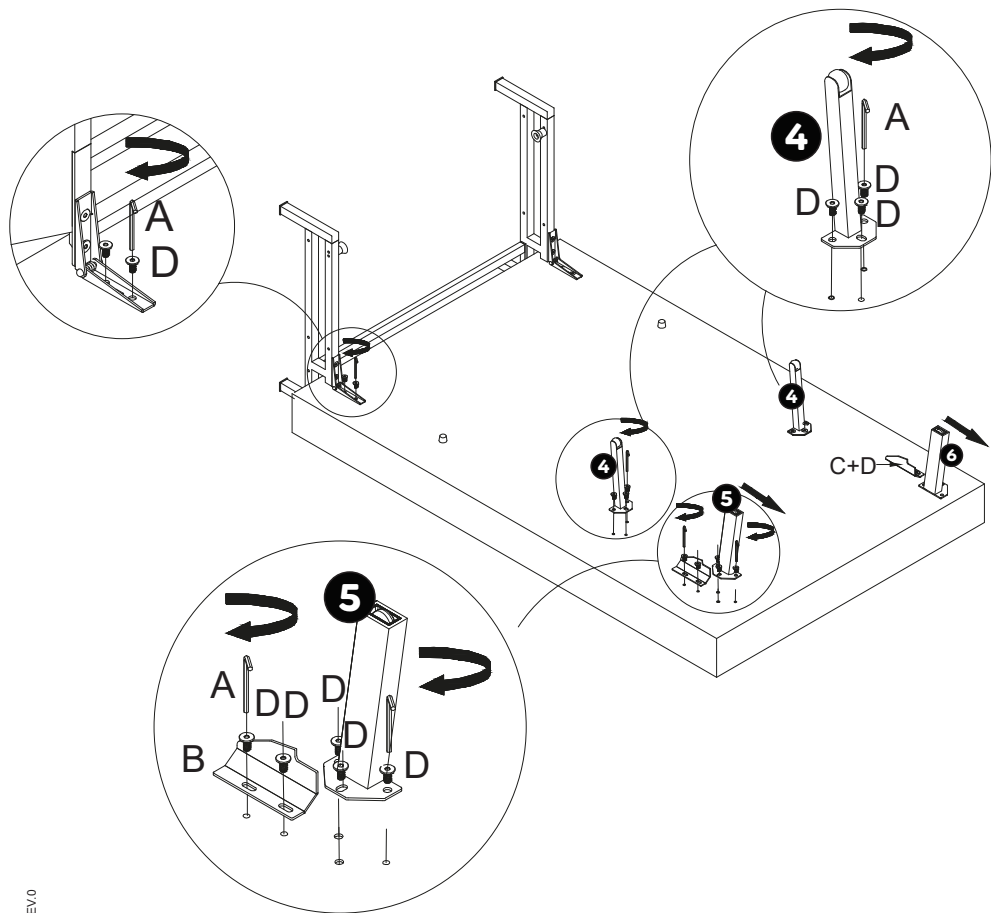

4

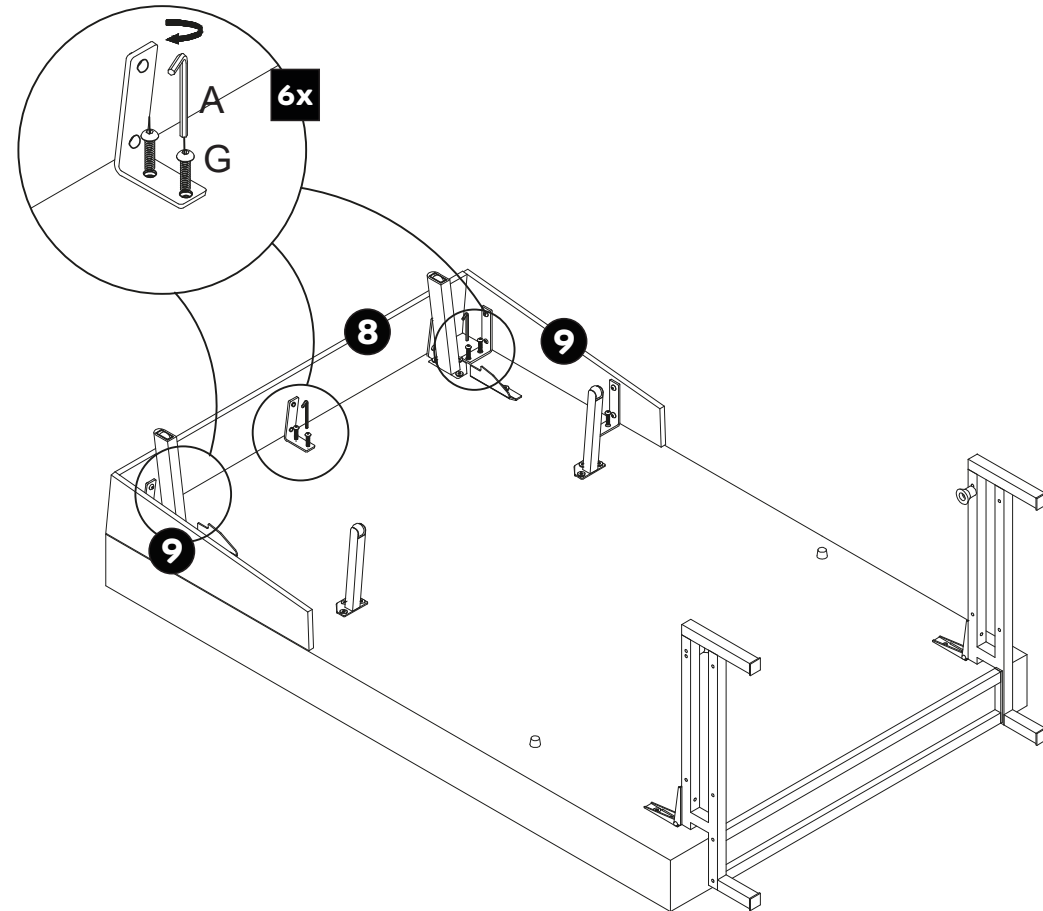

manuseio

